

Assembly Instructions

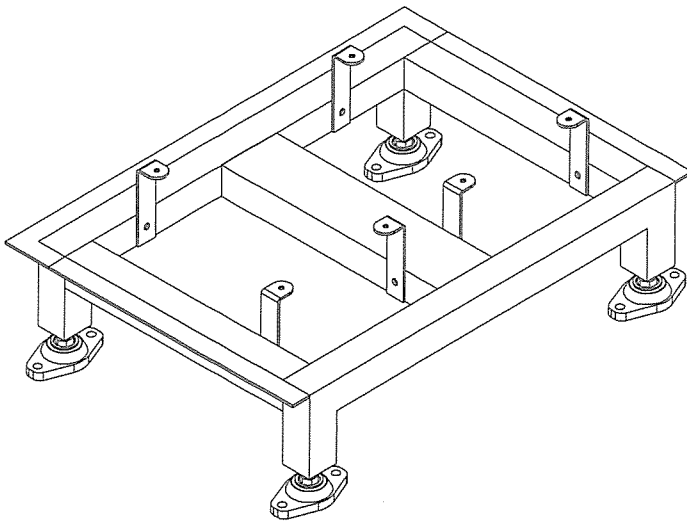

5.5mm drill bit is required (not supplied) to drill through the bottom of steel lockers to attach bolt

Bolt Screw 8x16 16PCS	Wood Screw 4x20 6PCS	for melamine lockers 99H 6PCS
Bolt Screw 6x12 6PCS	Allen Wrench M5 1PCS	for steel lockers 132H 6PCS
	 12x80 8PCS	 6PCS

STEP1

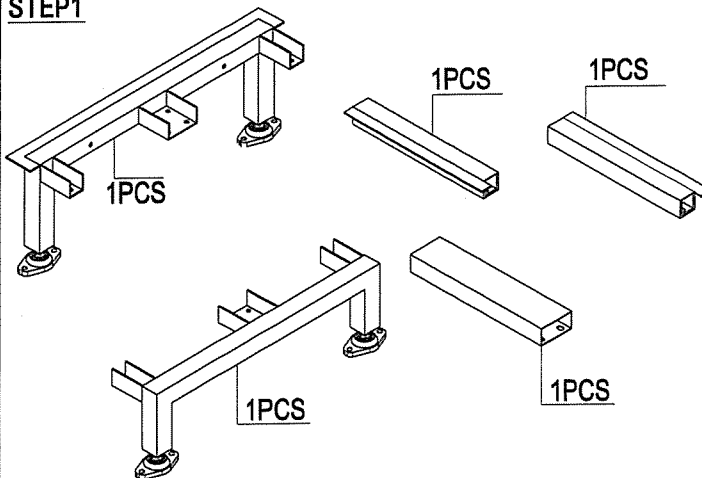

STEP2

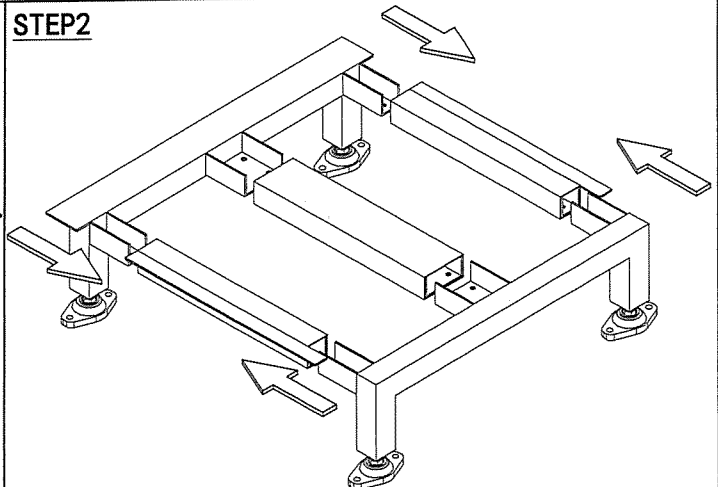

STEP3

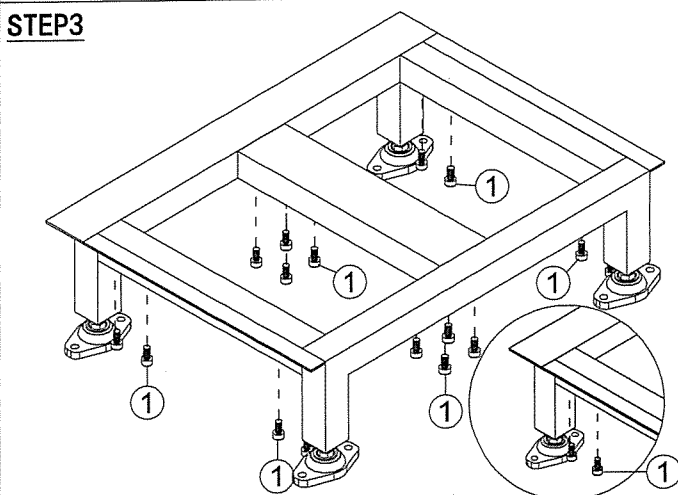

STEP4

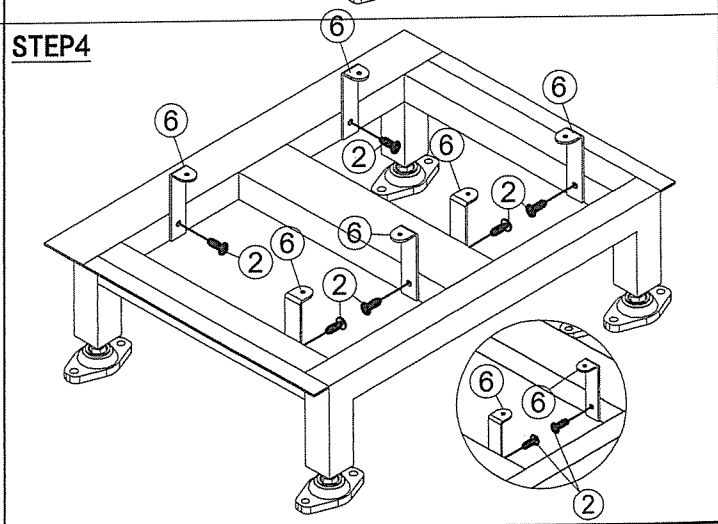

IMPORTANT NOTE:

- Place all laminated parts on a clean and smooth surface such as a rug or carpet to avoid the parts from being scratched.
- Check to be sure that you have all parts and hardware.
- Remove all wrapping materials, including staples & packing straps before you start to assemble.
- Don't tighten all screws/bolts until all completely assembled.
- Keep all hardware parts out of reach of children
- Do not drill holes for Dynabolts through flooring with membrane for waterproofing. Bolting of stands to floor to be done by others (Furnx installers do not bolt locker seats &/or stands to floor)

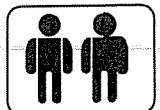

Assembly Instructions

STEP5

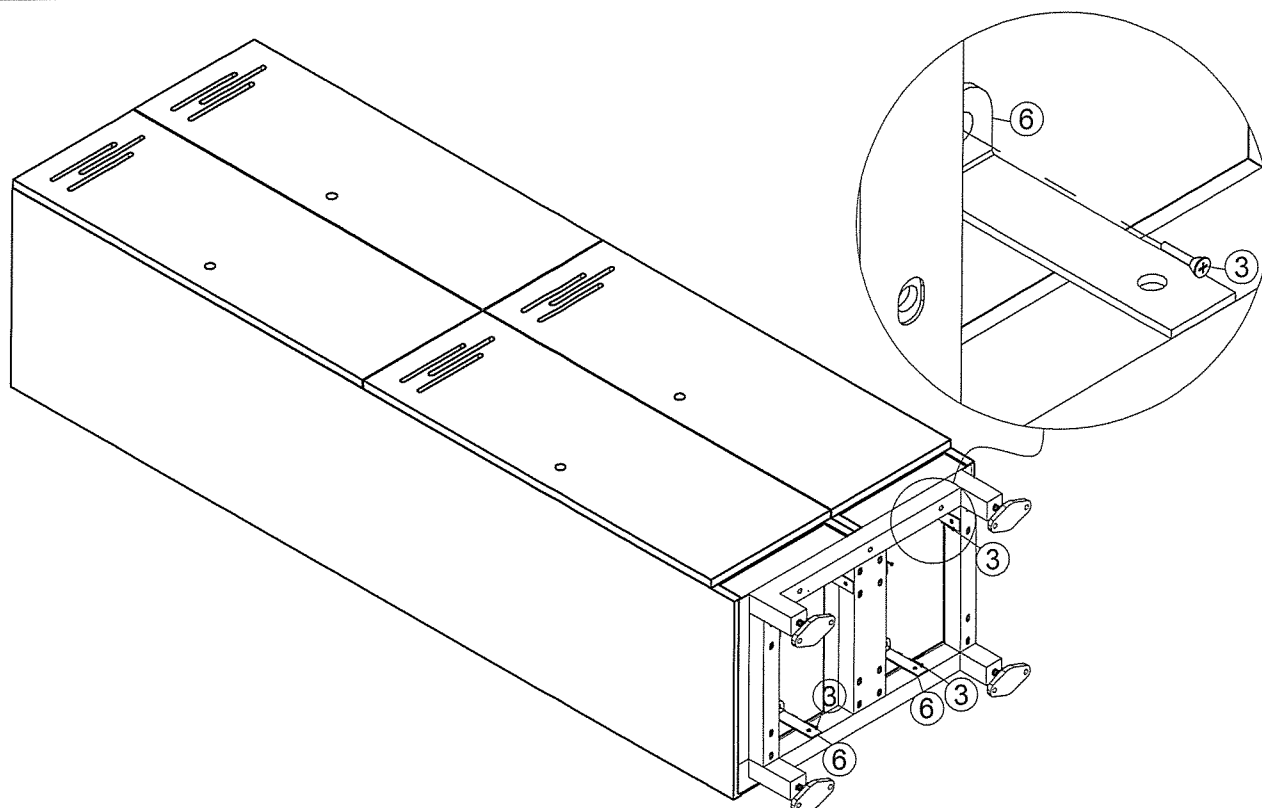

STEP6

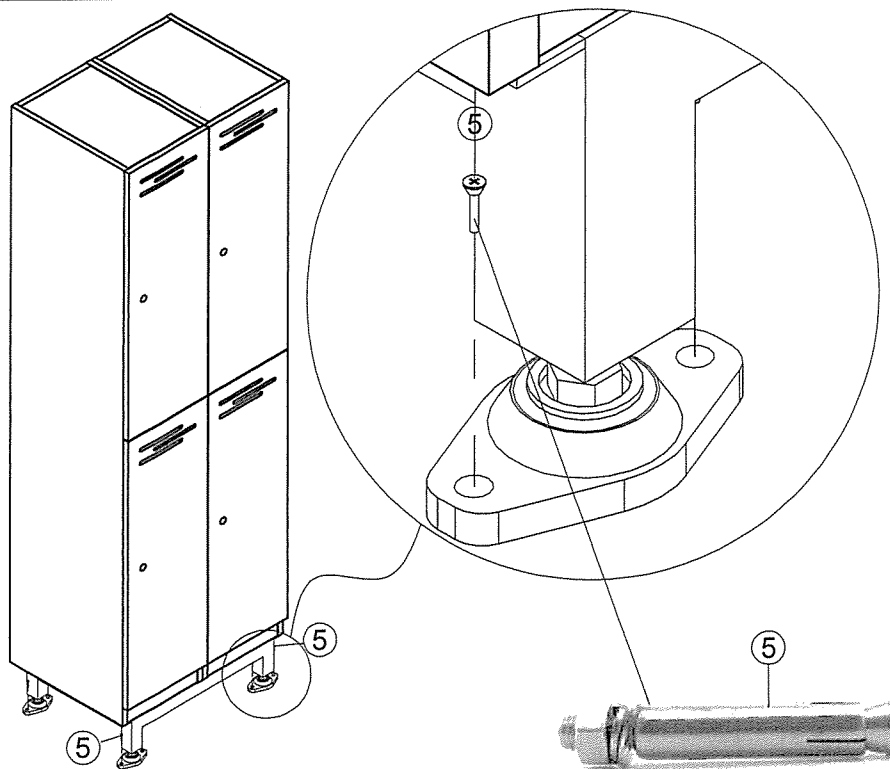

IMPORTANT NOTE:

- Place all laminated parts on a clean and smooth surface such as a rug or carpet to avoid the parts from being scratched.
- Check to be sure that you have all parts and hardware.
- Remove all wrapping materials, including staples & packing straps before you start to assemble.
- Don't tighten all screws/bolts until all completely assembled.
- Keep all hardware parts out of reach of children
- Do not drill holes for Dynabolts through flooring with membrane for waterproofing. Bolting of stands to floor to be done by others (Furnx installers do not bolt locker seats &/or stands to floor)

