

Assembly Instructions

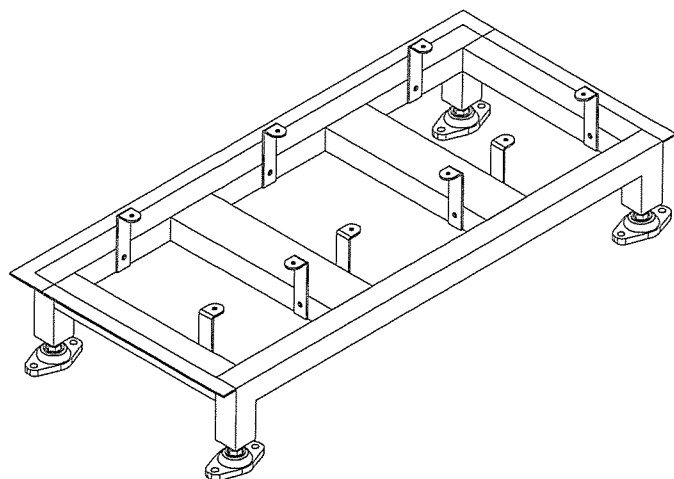

5.5mm drill bit is required (not supplied) to drill through the bottom of steel lockers to attach bolt

| | | |
|--|---|--|
| Bolt Screw 8×16 24PCS | Wood Screw 4×20 9PCS | for melamine lockers 99H 9PCS |
| Bolt Screw 6×12 9PCS | Allen Wrench M5 1PCS | for steel lockers 132H 9PCS |
| | 12×80 8PCS | 9PCS |

STEP1

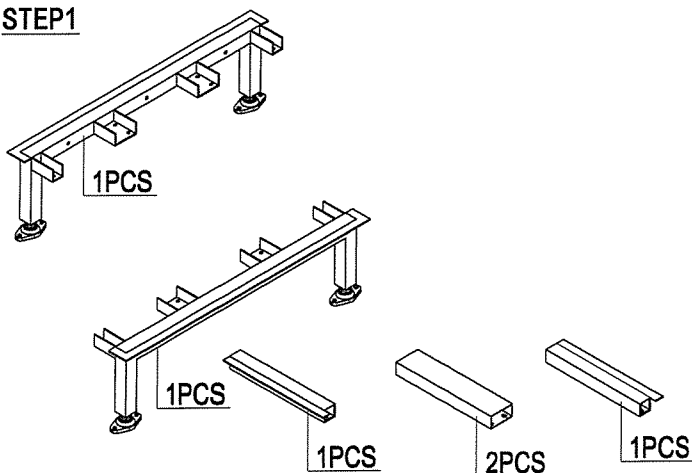

STEP2

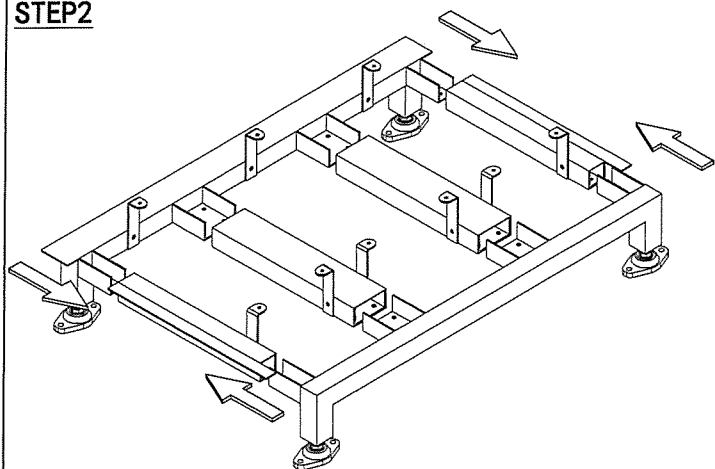

STEP3

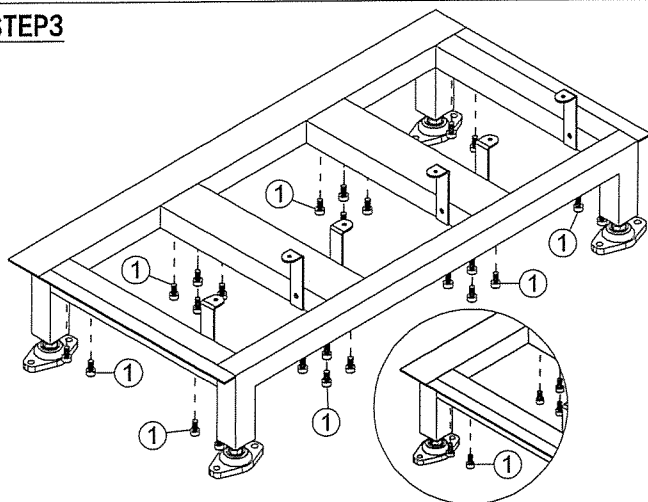

STEP4

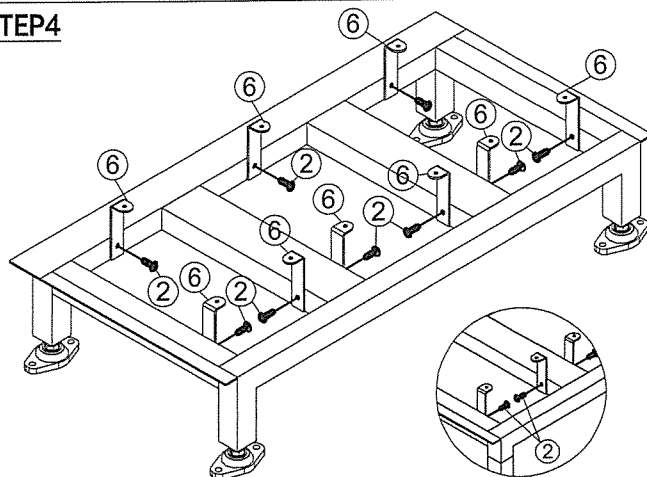

IMPORTANT NOTE:

- Place all laminated parts on a clean and smooth surface such as a rug or carpet to avoid the parts from being scratched.
- Check to be sure that you have all parts and hardware.
- Remove all wrapping materials, including staples & packing straps before you start to assemble.
- Don't tighten all screws/bolts until all completely assembled.
- Keep all hardware parts out of reach of children
- Do not drill holes for Dynabolts through flooring with membrane for waterproofing. Bolting of stands to floor to be done by others (Furnx installers do not bolt locker seats &/or stands to floor)

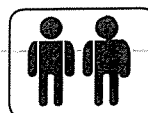

Assembly Instructions

STEP5

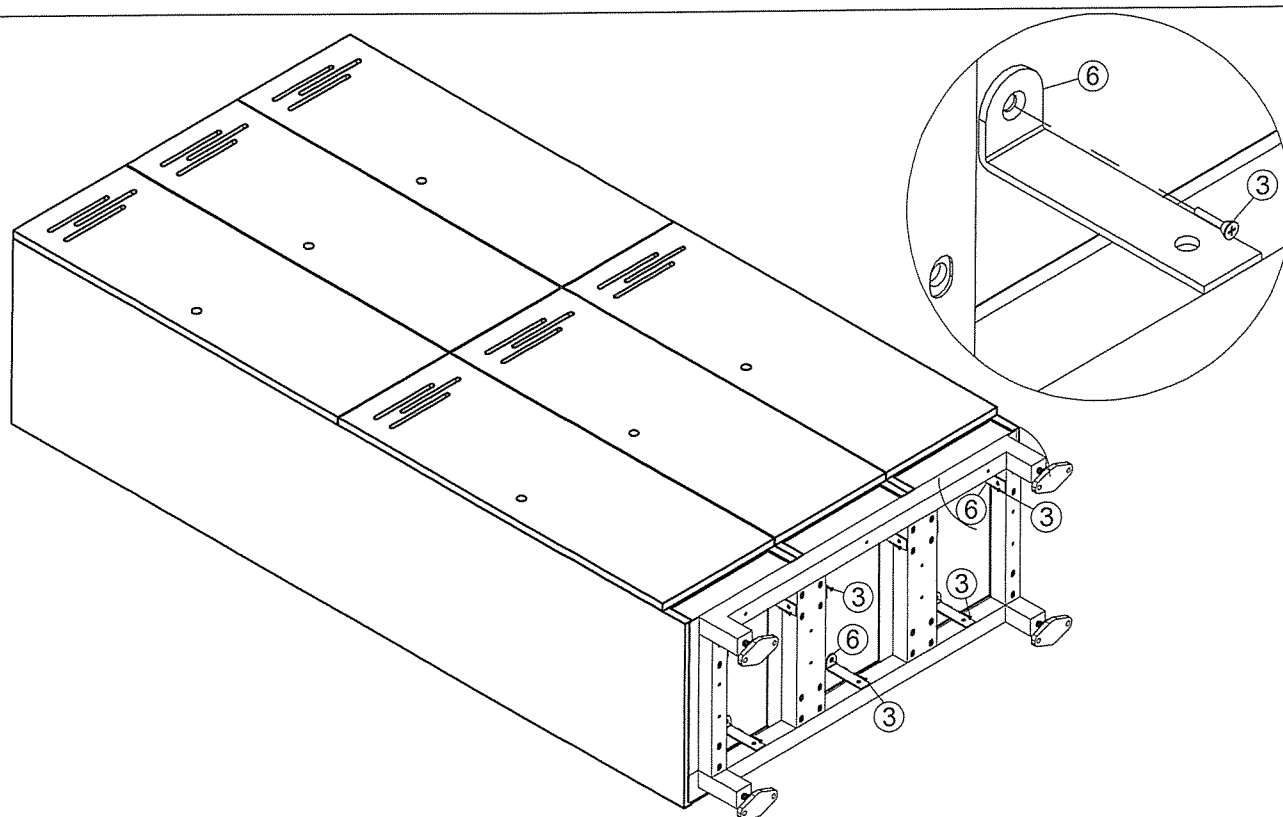

STEP6

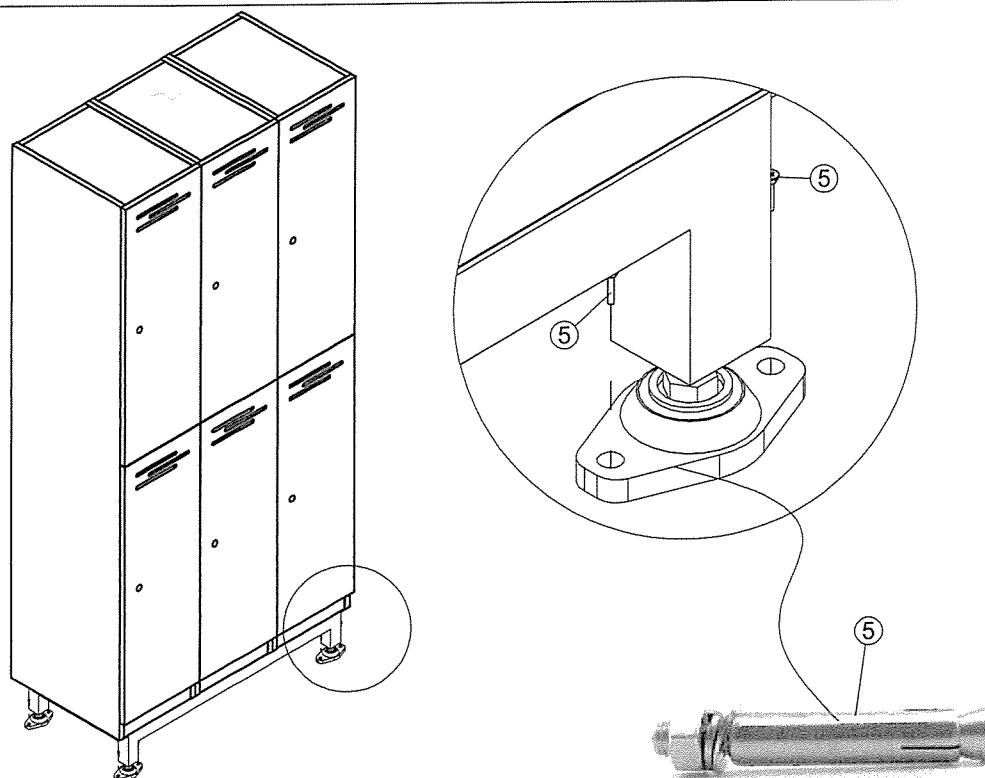

IMPORTANT NOTE:

- Place all laminated parts on a clean and smooth surface such as a rug or carpet to avoid the parts from being scratched.
- Check to be sure that you have all parts and hardware.
- Remove all wrapping materials, including staples & packing straps before you start to assemble.
- Don't tighten all screws/bolts until all completely assembled.
- Keep all hardware parts out of reach of children
- Do not drill holes for Dynabolts through flooring with membrane for waterproofing. Bolting of stands to floor to be done by others (Fumx installers do not bolt locker seats &/or stands to floor)

